

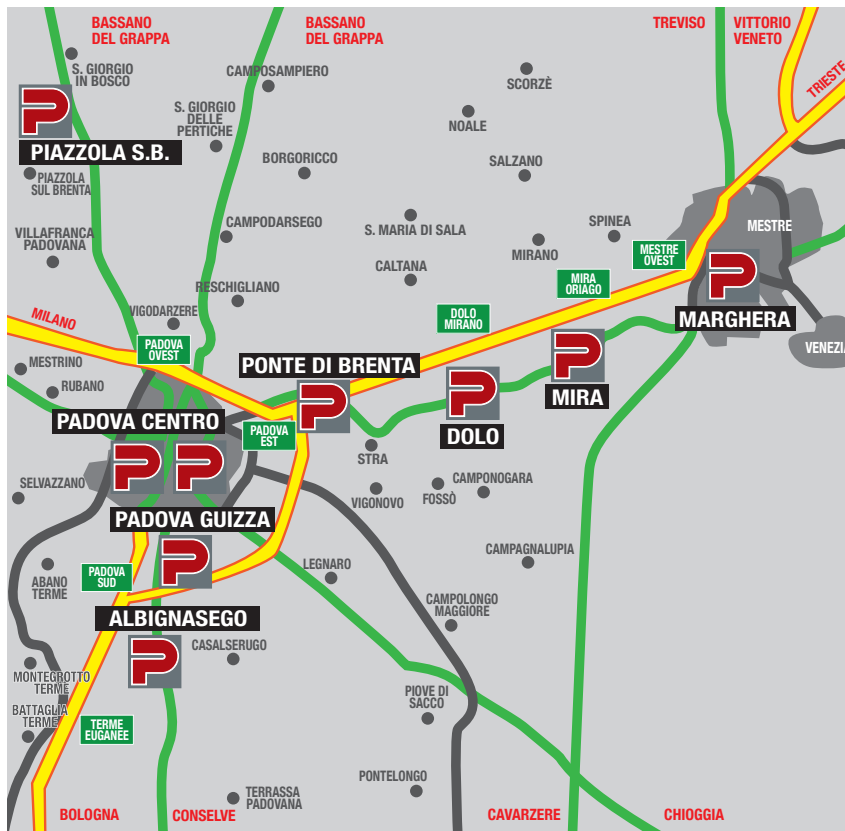

**INDICATIONS TO THE PATIENT**  
**PREPARATION FOR BLOOD SAMPLE**  
**EXTEMPORARY COLLECTION**  
**LABORATORY TEST**



## PRESENZA NEL TERRITORIO



### PRENOTAZIONI

#### ANALISI MEDICHE PAVANELLO

PADOVA LOC. PONTE DI BRENTA - Via Bravi, 61  
Tel. 049 6225200

#### DIAGNOSTICA PAVANELLO

MIRA (VE) - Via Bologna, 5/A  
Tel. 041 424700

## VENOUS TEST

Blood is collected usually from the central veins of the forearm (crook of the elbow).

### BEFORE THE TEST

Take a balanced diet and take sport during the previous days. Observe the fast and do not smoke in the previous 8-10 hours. It is possible to drink water. Abstain from eating and drinking alcoholics, especially coffee if you expect to do tests for the estimation of lipids and carbohydrates. Avoid the use of occasionally drugs. Particularly emotional subjects must tell it to the nurse so that she would lay down the person for doing the test.

### AFTER THE TEST

Keep the arm stretched out, the hand open and push the cotton pad in the tested zone without rub, for at least 5 minutes.

We recommend emotional subjects, pregnant women, children and people who are doing the test for the first time to stay in the hall of the Laboratory for a few minutes after the test. For any troubles please immediately inform the staff.

## ...DEDICATED TO CHILDREN AND THEIR PARENTS ADVICES FOR A QUIET TEST

### INTRODUCTION

Children in early childhood ( under 3 years ) are not able to express orally their emotions. For this reason they cry loud.

If children fall and hurt while playing, they cry not just because of the pain but for fear. Actually, sometimes children before crying take a look around to see parent's reaction. If parents look quiet it means that everything is ok and, probably they pick themselves up off the ground and go on playing. But if parents look scared then children start crying loud.

This is the reason why it would be better for parents to keep calm for passing to the children the message "it's ok, don't be scared".



### REFLECTIONS

Many children are afraid of doctors and parents often reproach them for this fear that appears ridiculous and childish for grown-up people. But it is necessary to be understanding and think that this fear is due to outward matters that don't come from the children. Anyway there are some remedies to take off the doctor the mask of the monster. It is essential to explain the children that doctor is a person like others, that he goes to the supermarket, has sons, so that the image of a strict man that always holds a syringe would be thrown away. Avoid using the figure of the doctor to convince the children to do something: "if you won't be good, I'll take you to the doctor". It is inevitable that children are afraid to go to the doctor.

It is important that the child understands that the doctor is a person who works to make him feel good and to let him run and play as he likes.

In other cases the cause of the problem is parent's behaviour. If you talk about the examination or about the blood test and you are worried about the health and the reactions of you children you will pass them your own anxiety. Children perceive every little tension and pay attention to non verbal language: a glance of scare, a worry in the tone of the voice doesn't help the children being calm.

### PREPARATION FOR BLOOD SAMPLE

It is important that parents don't tell lies, even if with a good purpose, because the child would not trust them.

It is better to warn him that he would probably feel a little pinch or a sting of mosquito. Attention must be

paid to the choice of words and expression that the child knows, avoiding negative sentences because our brain doesn't record the word "no". Instead of say: "Do not think about the pain" it is better to make him imagine what the child likes.

\* If your child is under 3 years old it is better to tell him just 2 or 3 days before. It is important to tell him that he is going to the laboratory with his mum, dad or another person that he knows and repeat the explanation many times to reassure him or her.

\*If your child is between 4 and 10 years, the explanation would be given a week before to let him think about and make questions. Always tell the truth in a suitable way helps the children facing up the problem. If parents first are worried about the test, the child would perceive the unusual event and would live it in a conflictual way. Always ask if he wants to keep with him a toy.

## **AFTER THE TEST**

It is important to cuddle the child after the test, even if he is grown-up, because in this moment children need to become a little "little baby" and to be cuddled. A kiss in the injury always is always a good solution and, after a few minutes, it would be enough tell them "look you are already cured" and the child would start smiling. It is possible to give a reward, something special to do with mum or dad or a little sweet or a little toy.

## **SPECIAL NURSERY RHYME**

### **For boys:**

*"Dragon and knight blood  
Just I'm waiting to fight besides of you  
with my little brave arm so light  
but please remember I'm a child knight"*

### **For girls:**

*"Strawberry blood so sweet and nice  
I like to fly like the lullaby  
And if I sting a wing with a rose spine  
I take its essence and continue to smile"*

*From the book "Dall'aerosol alla zeta"  
by Janna Carioli, Sinnos Editrice*



## SPECIAL INFORMATION FOR SPECIAL TESTS

### TEST FOR WHICH IS NECESSARY FASTING FOR 8 HOURS

P-ACIDI BILIARI	S-GASTRINA
S-ACIDO FOLICO	P-GLUCOSIO
P-ACIDO URICO	P-INSULINA
P-ALANINA AMINOTRANSFERASI (ALT)	P-MAGNESIO
P-ALBUMINA	P-ORMONE SOMATOTROPO (STH)
P-APOLIPOPROTEINA A1	P-PARATORMONE
P-APOLIPOPROTEINA B	P-PEPSINOGENO I
P-ASPARTATO-AMINOTRANSFERASI (AST)	P-PEPSINOGENO II
P-BILIRUBINA	S-POLIPEPTIDE PANCREATICO
P-BILIRUBINA TOTALE	P-POTASSIO
Sg-CALCIO IONIZZATO	P-PROTEINA C REATTIVA
P-CALCITONINA	P-SODIO
P-COLESTEROLO TOTALE	P-TIBC (CAPACITÀ TOTALE LEGANTE IL FERRO)
P-COLESTEROLO HDL	P-TRIGLICERIDI
P-COLESTEROLO LDL	S-VITAMINA A (Liposolubile)
P-C-PEPTIDE	P-VIP (PEPTIDE INTESTINALE VASOATTIVO)
Sg-ESAME EMOCROMOCITOMETRICO	S-VITAMINA B12
P-FERRO TOTALE	S-VITAMINA E (liposolubile)
P-FOSFATO INORGANICO	P-ZINCO

### DIAGNOSIS OF DIABETES

The laboratory's diagnostic for Diabetes, based on information from the National and International Scientific Societies, is executable in the manner described below.

#### ORAL LOADING GLUCOSE (Glucose determination and/or Insulin)

Fasting from the night before. Come to the laboratory at 7:30. The test involves a baseline blood test, the administration of a glucose solution, performing a blood test to 120'. Dwell time: 2 hours.

#### ORAL LOADING GLUCOSE (IN PREGNANCY) (Glucose determination and/or Insulin)

Fasting from the night before. Come to the laboratory at 7:30. The test involves a baseline blood test, the administration of a glucose solution, performing a blood test to 60' and to 120'. Dwell time: 2 hours.



## RENIN AND/OR ALDOSTERONE (Lying Down)

Fasting from the night before. Come to the laboratory at 7:30. The test includes a 2 hour period of stabilization in reclining position before performing blood test. Dwell time: 2 hours.

## PROLACTIN DETERMINATION / PROLACTIN PULSATILITY

The test includes a 20 minutes period of stabilization in reclining position before performing blood test. Dwell time: 20 minutes if only one dosage is required. Dwell time: 1 hour if are required three dosages (pulsatility).

## GASTROPANEL

The test helps to assess the presence of gastritis. The patient must stay for at least 15 days of any drug therapy performed with antibiotics or drugs affecting gastric secretion, unless otherwise indicated by your doctor. The day before of execution test the patient should not drink alcohol and should fast from midnight.



## EXTEMPORARY URINE COLLECTION (First urination of the morning)

After a careful cleansing of the hands and genitalia, pick up the intermediate part of urine of the first morning urination in a sterilized container for urine; ideal volume: 20-30 mL, minimum volume: 10 mL for complete urine test and 10 mL for urine culture. Deliver in the same morning to the laboratory. The sterilized container (plastic jar with screw cap and hole for vacuum tubes) is distributed by: Laboratory, Pharmacy, Pharmaceuticals, Sanitary items.

### ANALISYS

U-ESAME COLTURALE DELLE URINE

U-ESAME COLTURALE DELLE URINE (first urination)

U-ESAME COLTURALE DELLE URINE (second urination)

U-ESAME COLTURALE DELLE URINE (third urination)

U-ESAME COLTURALE DELLE URINE (after prostate massage)

U-ESAME COMPLETO DELLE URINE

U-ESAME COMPLETO DELLE URINE (at rest)

U-ESAME COMPLETO DELLE URINE (after prostate massage)

U-ESAME COMPLETO DELLE URINE (after effort)

U-ESAME COMPLETO DELLE URINE (first urination)

U-ESAME COMPLETO DELLE URINE (second urination)

U-ESAME COMPLETO DELLE URINE (third urination)

U-ESAME DELLE URINE (phase contrast)

# URINARY CYTOLOGY

## EXAMINATION OF URINARY CYTOLOGY ON 3 SAMPLES

### THE CYTOLOGICAL EXAMINATION MUST BE PERFORMED ON 3 URINE SAMPLES COLLECTED IN 3 CONSECUTIVE DAYS

The collection of urine **must be started within 2 days prior to the date of delivery of the samples** (eg if the delivery is for Monday, the urine must be collected on Saturday, Sunday and Monday morning).

To carry out the examination you were given a package containing: **three pre-filled containers with liquid suitable for storing and transporting urine samples and three labels Self-adhesive.**

**PRECAUTIONS FOR USE:** The liquid in the containers is FLAMMABLE. Don't drink it and keep the containers out of reach of children. In case of contact with eyes, wash immediately abundantly with water. Keep containers away from flames and sparks.

### COLLECTION INSTRUCTIONS

1. Write your personal data (SURNAME, NAME, DATE OF BIRTH) and the date of collection on 3 self-adhesive labels supplied and applied to the 3 corresponding containers. Store containers at room temperature, away from heat or direct light.
2. The urine must not be those of the night, but the second ones of the morning (eg morning urinates normally, drink 2 or 3 glasses of water and then collect the urine).
3. On the first day of collection, open the container 1 containing the liquid and introduce the emitted urine, until reaching the maximum level (just below the edge of the container). Carefully close the container with the relative screw cap and keep it in room temperature.
4. Repeat the procedure on the second and third day, using the containers identified with "Container 2" (second day urine sample and "Container 3" third day urine sample).
5. Introduce the three samples in the package.

Fasting is not needed. **THE THREE SAMPLES MUST BE DELIVERED TOGETHER IN THE SAME DAY AT DRAWING POINTS OF THE ANALYSIS LABORATORY**



## EXAMINATION OF URINARY CYTOLOGY ON 1 SAMPLE ONLY

### THE CYTOLOGICAL EXAMINATION MUST BE PERFORMED ON 1 URINE SAMPLE COLLECTED ON THE SAME DAY OF THE DELIVERY.

To carry out the examination, you were given a package containing: **a pre-filled container with liquid suitable for storing and transporting the urine sample and a label Self-adhesive.**

**PRECAUTIONS FOR USE:** The liquid in the container is FLAMMABLE. Don't drink it and keep the container out of reach of children. In case of contact with eyes, wash immediately abundantly with water. Keep container away from flames and sparks.

### COLLECTION INSTRUCTIONS

1. Write down your personal data (SURNAME, NAME, DATE OF BIRTH) and the date of collection on the self-adhesive label provided and apply it to the sample. Keep the container so prepared at room temperature, away from heat or direct light.
2. The urine must not be those of the night, but the second ones of the morning (eg morning urinates normally, drink 2 or 3 glasses of water and then collect the urine).

Fasting is not needed. **THE SAMPLE MUST BE DELIVERED IN THE SAME DAY OF THE COLLECTION AT THE POINT OF DRAWINGS OF THE ANALYSIS LABORATORY.**

## 24 HOURS URINE COLLECTION (Without preservatives acids)

Discard the first urination of the morning (hour 7 a.m.) and collect all the urine of the day, night and urine of the day after (hour 7 a.m.) in a special container which, when collected, should be stored in the refrigerator. Deliver in the same morning, the entire volume collected to the laboratory, or stir the content, measure the volume and transfer 30-40 mL of urine in container. Mark diuresis on the container. The container for the collection of 24 hours (jar-shaped or cylindrical ) is distributed by: Pharmacy, Pharmaceuticals, Sanitary items.

### ANALISYS

dU-17-CHETOSTEROIDI	dU-GLUCOSIO
dU-ACIDO CITRICO	dU-IODIO
dU-ALDOSTERONE	dU-MERCURIO
dU-Alfa-AMILASI	dU-NICHEL
dU-ANALISI IMMUNOELETTROFORETICA	dU-PIOMBO
dU-ARSENICO	dU-POTASSIO
dU-CADMIO	dU-PROTEINE DI BENICE-JONES
dU-COLORO	dU-PROTEINE TOTALI
dU-COBALTO	dU-RAME
dU-CONTA DI ADDIS	dU-SEROTONINA
dU-COPROPORFIRINE	dU-SODIO
dU-CORTISOLO LIBERO	dU-UREA
dU-CREATININA	dU-UROPORFIRINE
dU-CROMO	S-dU-CREATININA CLEARANCE (requires blood test)



## 24 HOURS URINE COLLECTION (With preservatives acids)

Before you start, put in the container the preservative acid provided by the Laboratory. Discard the first urination of the morning (hour 7 a.m.) and collect all the urine of the day, night and urine of day after (hour 7 a.m.) in a special container which, when collected, should be stored in the refrigerator. Deliver in the same morning, the entire volume collected to the laboratory (preferred practice), or stir the content, measure the volume and transfer 30-40 mL of urine in container. Mark the total urine output on it.

The container for the collection of urines in the 24 hours (jar-shaped or cylindrical) is distributed by: Pharmacy, Pharmaceuticals, Sanitary items.

The preservative acid should be applied to the laboratory before starting the collection of urine over 24 hours. The substance is contained in a plastic tube with a pressure yellow cap labeled with the name of the substance. Uncork the tube and pour the contents (liquid or solid depending on the type of substance) in the container of urine for 24 hours.

**CAUTION: DO NOT SWALLOW. DO NOT LEAVE THE REACH OF CHILDREN. IN CASE OF ACCIDENTAL INGESTION MAKE REFER TO MORE NEAR FIRST AID. IN CASE OF CONTACT WITH SKIN MUST WASH WITH PLENTY OF WATER. IN CASE OF ACCIDENTAL CONTACT TO THE EYES WASH WITH PLENTY OF WATER AND CONSULT THE MOST NEAR FIRST AID.**

### PRESERVATIVES ACIDS:

ACIDO CLORIDRICO 6 N (10 mL)

SODIO IDROSSIDO 1 N (10 mL)

CARBONATO DI SODIO (5 g)

### ANALISYS

dU-ACIDO 5-OH-INDOLACETICO

dU-ACIDO OMOVANILLICO

dU-ACIDO VANILMANDELICO

dU-ADRENALINA

dU-CALCIO TOTALE

dU-DOPAMINA

dU-FOSFATO INORGANICO

dU-MAGNESIO

dU-METANEFRINA

dU-METOSSITIRAMINA

dU-NORADRENALINA

dU-NORMETANEFRINE

dU-ACIDO OSSALICO

dU-ACIDO URICO

dU-Beta-2-MICROGLOBULINA

## COLLECTION OF FECES for physical chemical or bacterial culture examination

Collect the feces in a container in an adequate amount (if are solid like an olive, if are liquid a few ml). Never fill the container completely and close it carefully. It is preferred collecting the feces in the same morning of the delivery to the laboratory. Samples collected in the evening, preserved in the refrigerator and delivered the morning after are also acceptable. In the case of prescription of multiple exams (usually three samples), collection and delivery must take place in three successive mornings. The container (plastic jar with a pressure cap and spatula) is distributed by: Laboratory, Pharmacy, Pharmaceuticals, Sanitary items.

F-Alfa-1-ANTITRIPSINA  
F-CALPROTECTINA\* (frozen sample)  
F-CHIMOTRIPSINA  
F-ELASTASI 1 PANCREATICA\* (frozen sample)  
F-ESAME CULTURALE DELLE FECI  
F-ESAME CULTURALE PER RICERCA LIEVITI  
F-ESAME CULTURALE RICERCA CAMPYLOBACTER  
F-ESAME COMPLETO DELLE FECI  
F-ESAME CULTURALE  
PER RICERCA E.COLI ENTEROPATOGENI

F-RICERCA Ag-HELYCOBACTER PYLORI (HpSA)+B47  
F-RICERCA DIRETTA TOSSINA DI C. DIFFICILE  
F-RICERCA ANTIGENE GIARDIA  
F-RICERCA CLOSTRIDIUM DIFFICILE  
F-RICERCA CRYPTOSPORIDIUM SP  
F-RICERCA EOSINOFILI  
F-RICERCA ROTAVIRUS  
F-RICERCA SANGUE OCCULTO  
F-RICERCA YERSINIA ENTEROCOLITICA  
F-RICERCA ADENOVIRUS

## COLLECTION OF FECES TO SEARCH PARASITES

Collect the feces in a container in an adequate amount (if are solid like an olive, if are liquid a few ml). Never fill the container completely and close it carefully. Collect the stool in the morning if possible before delivery to the laboratory. Are acceptable stool samples collected earlier in the evening and kept at room temperature. The container (plastic jar with a pressure cap and spatula) is distributed by: Laboratory, Pharmacy, Pharmaceuticals, Sanitary items.

### ANALISYS

F- RICERCA ENTAMOEBIA HISTOLITICA (only sample of the morning)  
F-RICERCA GIARDIA INTESTINALIS  
F-RICERCA PARASSITI  
F-RICERCA PARASSITI (1° sample)  
F-RICERCA PARASSITI (2° sample)  
F-RICERCA PARASSITI (3° sample)

## SCOTCH-TEST FOR RESEARCH PARASITIES

Withdraw Laboratory microscope slides with the appropriate carrying case.

In the morning, upon awakening, apply a strip of clear tape (similar in size to the glass slide provided) onto the skin of the perianal area for a few minutes. The tape allows you to capture the eggs deposited by the pinworm's larvae that migrate throughout the night until the anal opening. Then remove the tape and make it stick, stretched on the surface of the glass slide. Deliver in the morning to the Laboratory.

### ANALISYS

F-RICERCA PARASSITI da SCOTCH-TEST

## COLLECTION OF FAECES TO SEARCH OCCULT BLOOD

Sample collection should be performed using the special container with preservative liquid. It is possible to collect the container at the analysis laboratory structure

- Do not collect the sample during or within 3 days of the menstrual cycle and or while you are suffering from bleeding hemorrhoids.
- Avoid contaminating the faeces with urine.
- Alcohol, aspirin, and other medicines taken in excess can cause gastrointestinal irritation that causes occult bleeding.  
These substances should be discontinued at least 48 hours before the test.
- No food restrictions are required before testing.

### Sample collection method

- Collect a small quantity of faeces and place it inside the container as follows:
  - Remove the green cap from the container, turning it to the left and pulling it upwards
  - Take the stool sample with the sampling probe by rubbing different areas of the stool surface. Take a sufficient quantity to cover the spiral of the probe;
  - Insert the sampling probe into the container and close the cap.
  - Do not repeat this operation more than once;
  - Shake the container vigorously by turning it up and down several times.

### Note:

In the case of hard stools, moisten them with water before taking the sample with the sampling probe.

- The sample thus collected must be stored in the refrigerator and delivered within 3 days of collection.
- If the exam is on 3 samples, repeat the operation

## ANALISYS

F-RICERCA SANGUE OCCULTO

F-RICERCA SANGUE OCCULTO (1° sample)

F-RICERCA SANGUE OCCULTO (2° sample)

F-RICERCA SANGUE OCCULTO (3° sample)

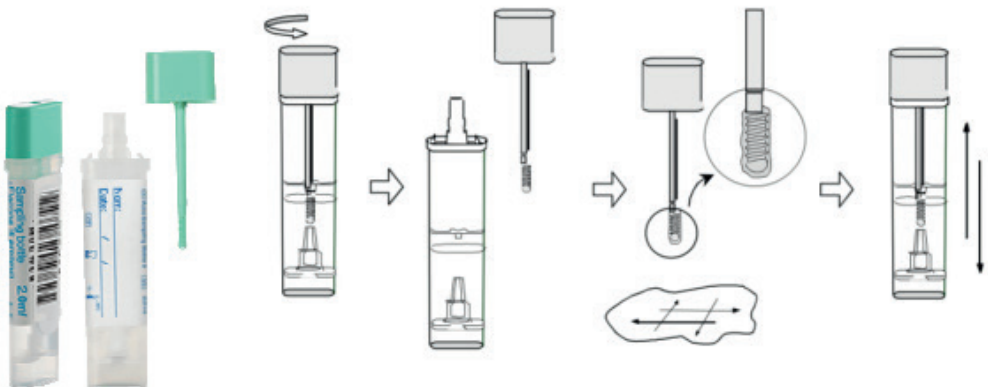

## COLLECTION OF LIQUID SEMINAL

### EVALUATION MOTILITY AND VITALITY OF HUMAN SPERM

Observe a period of sexual abstinence from 2 to 7 days. Collect the semen obtained by masturbation, ejaculating directly into a sterile container. The delivery to the laboratory (Reception 9:30 - 10:00) must be done within 30 minutes of collection. The sample must be kept at 20°-35° C. The sterilized container (plastic jar with screw cap) is distributed by: Laboratory, Pharmacy, Pharmaceuticals, Sanitary items.

### ANALISYS

Ls-ESAME DEL LIQUIDO SEMINALE



## OTHER ANALYSIS OF SEMINAL LIQUID

Other tests on the semen does not require such precise timing for the collection. They can then be collected and delivered to the laboratory in the morning in the normal time of acceptance.

The sterilized container (plastic jar with screw cap) is delivered by: Laboratory, Chemistry, Drugstore, Sanitary items.

### ANALISYS

Ls-Ac-ANTI-SPERMATOZOO

Ls-ESAME COLTURALE DEL LIQUIDO SEMINALE

Ls-RICERCA CHLAMYDIA TRACHOMATIS

Ls-RICERCA MYCOPLASMI

Ls-RICERCA TRICHOMONAS V.

Ls-RICERCA NEISSERIA GONORRHOEAE

Ls-RICERCA MYCOPLASMI

## COLLECTION SPUTUM

Collect the sample in the morning, at fast in a sterilized container (like urine container). Before the collection carefully cleansing of the oral cavity with water gargles. Collect the deep expectoration eventually helping the emission through cough. Samples of superficial origin are not suitable for examinations.

The container (plastic jar with screw cap) is delivered by: Laboratory, Chemistry, Drugstore, Sanitary items.

### ANALISYS

Es-as-ESAME CITOLOGICO DELL'ESCREATO

Es-ESAME CITOLOGICO DELL'ESCREATO

Es-RICERCA MICOBATTERI NELL'ESCREATO

## BREATH TEST FOR THE HELICOBACTER PYLORY SEARCH

Breath examination to check for the presence or absence of infection. The patient must present himself fasting from midnight, without having drunk, smoked, brushed teeth and without having taken drugs Antisecretory agents in the 15 days preceding the examination.

Do not take Antibiotics or bismuth salts in 30 days preceding the exam.

## PREPARATION OF THE PATIENT FOR THE EXECUTION OF THE H<sub>2</sub> BREATH TEST FOR THE DIAGNOSIS OF LACTOSE INTOLERANCE

1. In the seven days preceding the examination the patient must not take drugs based on antibiotics, lactic ferments, laxatives;
2. The doctor must ensure that the patient does not have an important diarrhea;
3. The patient the day before the exam must feed exclusively with:
  - **BREAKFAST:** a cup of tea
  - **LUNCH:** a dish of boiled rice with a little oil
  - **DINNER:** a steak or a boiled fish with salad
4. From 9.00 pm the day before the exam the patient **MUST** observe a complete fast (he can drink water freely);
5. From 7:00 am on the day of the exam the patient **MUST** drink two glasses of water, remain fasting, do not smoke, do not brush his teeth, do not exercise.

**ATTENTION as the exam lasts 4 hours in total and can be performed at:**

PADOVA Ponte di Brenta - via Bravi n.51 - ground floor - at 7:00

MIRA - VE - via Bologna n. 5 / A - first floor - at 7:00

**After booking the health service at 049 6225200.**

## THE INTESTINAL PERMEABILITY TEST WITH 3 SUGARS (*lactose, mannitol, sucrose - PINTZ test*)

Allows to evaluate the presence of an increase in the permeability of the small intestine.

### CONTRAINDICATION AT THE EXECUTION OF THE TEST

- Documented previous diagnosis of diabetes mellitus.
- Diabetic patients can still carry out the test with the consent of their doctor.

### MATERIAL FOR THE EXECUTION OF THE TEST

Equip yourself with:

- 1 24-hour urine container, or recycled water bottle,
- 1 sterile urine jar.

In the test pack there are 2 containers included:

- SUGAR container to be taken and - container CONSERVING urine (vial).

**WARNINGS** Keep all material out of the reach of children; CONSERVANT urine is toxic if ingested.

### METHOD OF EXECUTION OF THE TEST

Do not take antibiotics for 4 weeks before the test, do not take antisecretory drugs, probiotics, prebiotics, lactulose-based laxatives for 2 weeks before the test; do not take anti-inflammatory drugs and aspirin the week before the test; for women of childbearing age the menstrual cycle must have been completed for at least a week. To perform this exam you must be fasting from midnight. Do not drink alcohol (wine, beer, liquor) the night before the exam. During the 6-hour urine sample collection test, a maximum of one glass of water is allowed, but do not eat or smoke.

Urine can only be collected in a recycled water bottle or by using a urine collection container 24 hours to be taken at the pharmacy. **THE SUGAR CONTAINER PRESENT IN THE PACKAGE CANNOT BE ABSOLUTELY USED FOR URINE COLLECTION.**

### METHOD

- Start the test not before 6:30 am and discard the first morning urine by urinating directly into the toilet.
- Pour the contents of the vial with preservative into the urine collection container.  
(The preservative makes the urine cloudy and **toxic if ingested**).
- Dilute the solution of SUGARS present in the container in **about 100ml of water** for the intake - For children under the age of 10 years it may be sufficient to dilute the solution of SUGARS in **about 50 ml of water**.
- Mix well and drink all the solution created.
- **Collect ALL the urine in the following 6 hours in the 24-hour urine container** (or in the recycled water bottle), taking care to keep the container cool (refrigerator or cooler with refrigerants).
- At the end of the 6-hour collection, **measure the total volume collected and transfer 30-40 ml of urine into a sterile urine collection jar**.
- At the time of delivery of the urine jar **indicate to the personnel assigned to the acceptance the total volume collected** and any inconveniences occurred during the execution of the test (for example: incomplete intake of sugars, loss of part of the urine, incorrect conservation of the sample).

## COLLECTION OF BIOLOGICAL SAMPLES THROUGH A SWAB

### AURICULAR SWAB



Do not clean the auricular canal in the hours that precede the exam. Do not use medications in the ear.

### THROAT SWAB, LINGUAL MUCOSA, GINGIVAL MUCOSA

Do not make gargles or rinse of the oral cavity. Do not use brush tooth and toothpaste. Do not smoke in the previous hours.



### NASAL SWAB



Don't instill drugs into the nose in the hours prior to collection. Don't wash nostrils.

### OCULAR SWAB

Do not wash the eyes. Do not instill medications (eye drops) in the eye. Do not use eye ointment in the hours prior to collection.

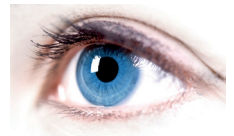

### SKIN SWAB

Do not wash and / or do not to disinfect the pick-up zone. The nails must not have been cut in previous days and should not be made use of disinfectants or antifungal.

## URETHRAL SWAB

Do not urinate within 4 hours before the exam.

## VAGINAL SWAB

Do not be menstruating. Do not have sex, do not use douches or medicines for local use within 24 hours before the exam.

## COMBINED TEST 1<sup>st</sup> QUARTER OF PREGNANCY - ULTRASCREEN

The test should be performed between 11<sup>th</sup> and 13<sup>th</sup> weeks + 6 days of gestation. The patient must deliver an ultrasound measurement of nuchal translucency and CRL performed by no more than 5 days. For the blood test the fast is not need.



**CENTRO UNICO PRENOTAZIONI**  
**Tel. 049 6225200**

---

***[www.pavanellogroup.it](http://www.pavanellogroup.it)***